

Planta de cimentación
e 1.100

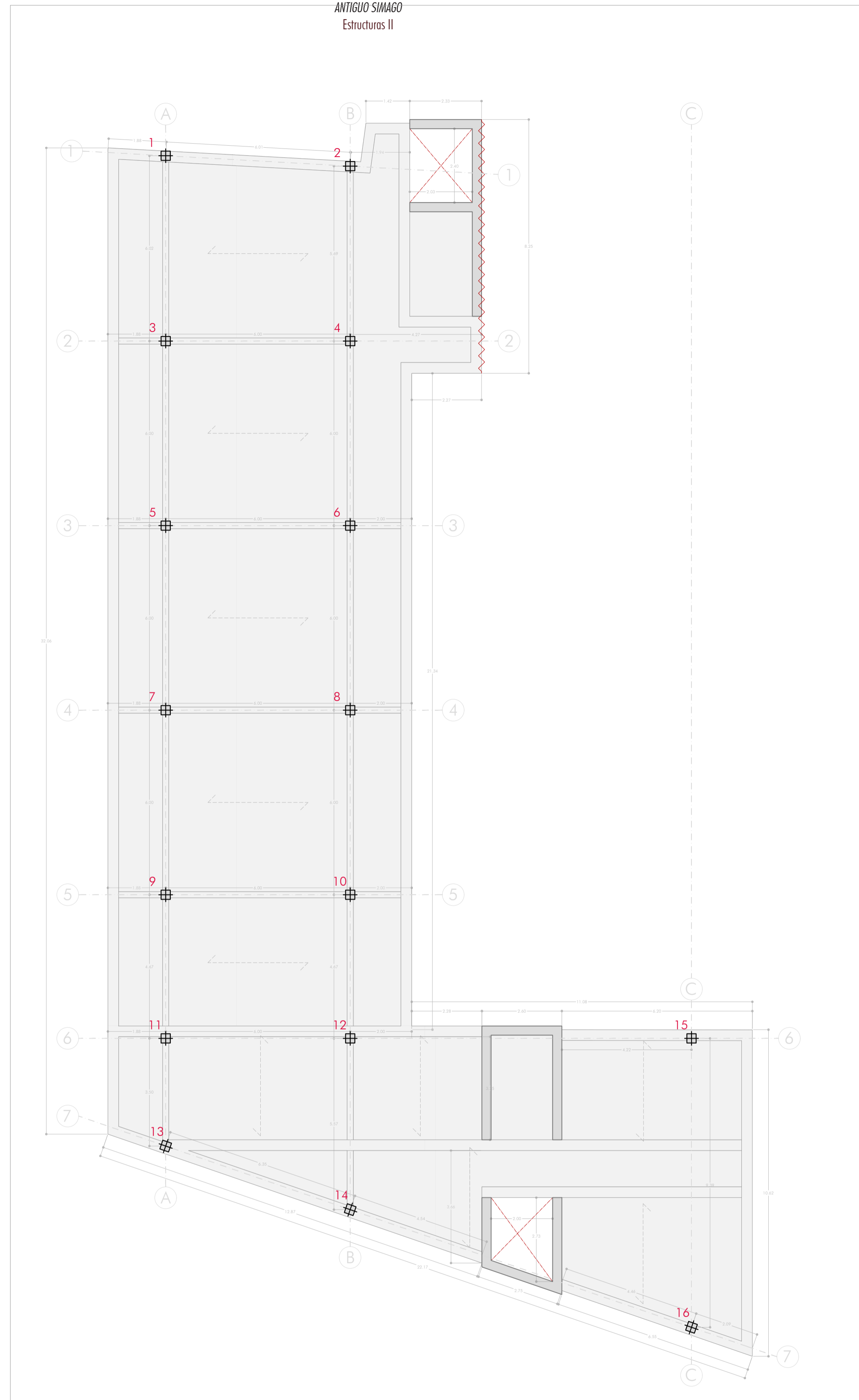

Planta baja - Forjado sanitario
e 1.100

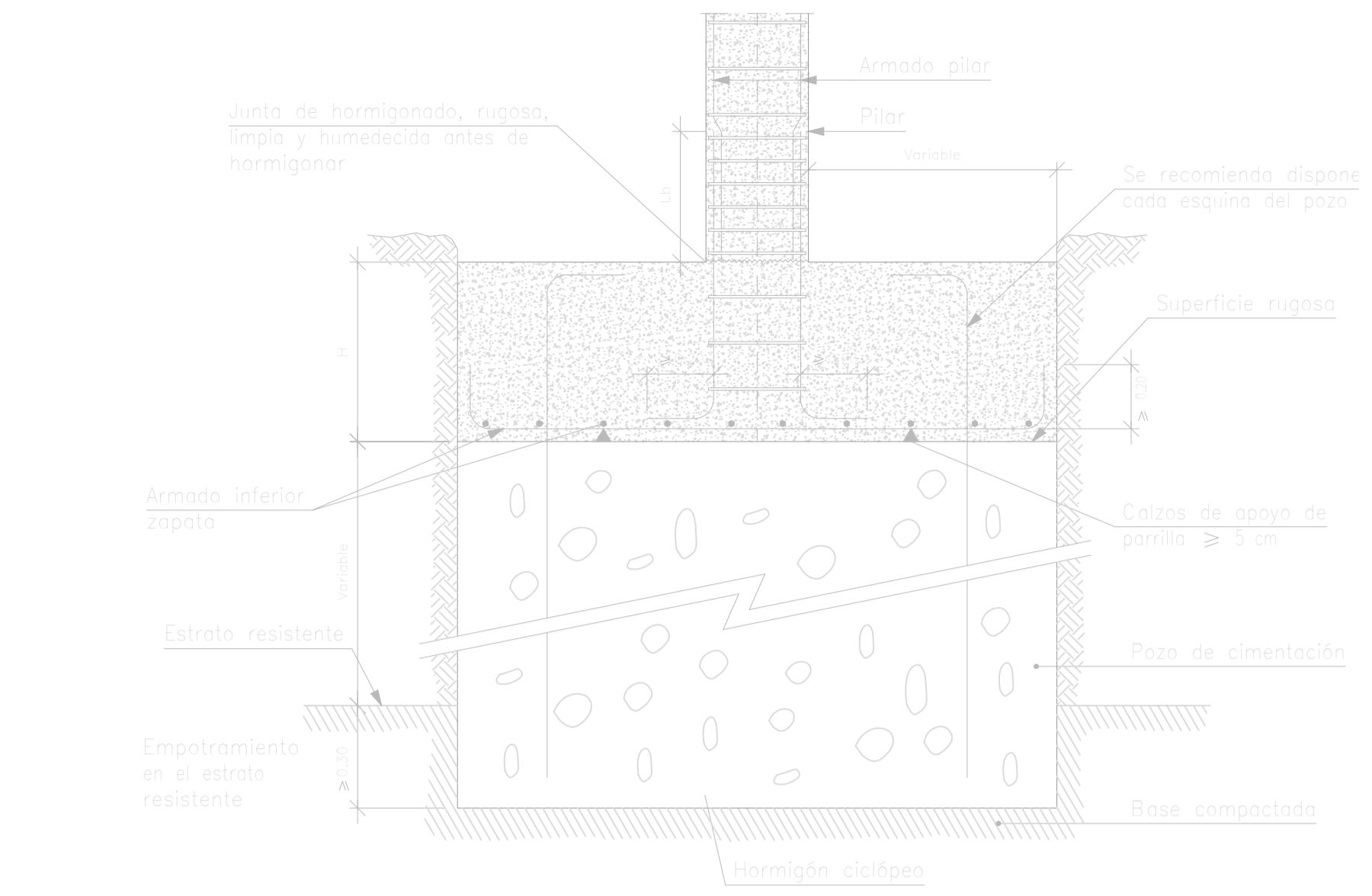

Detalle zapata sobre pozo de cimentación
e 1.20

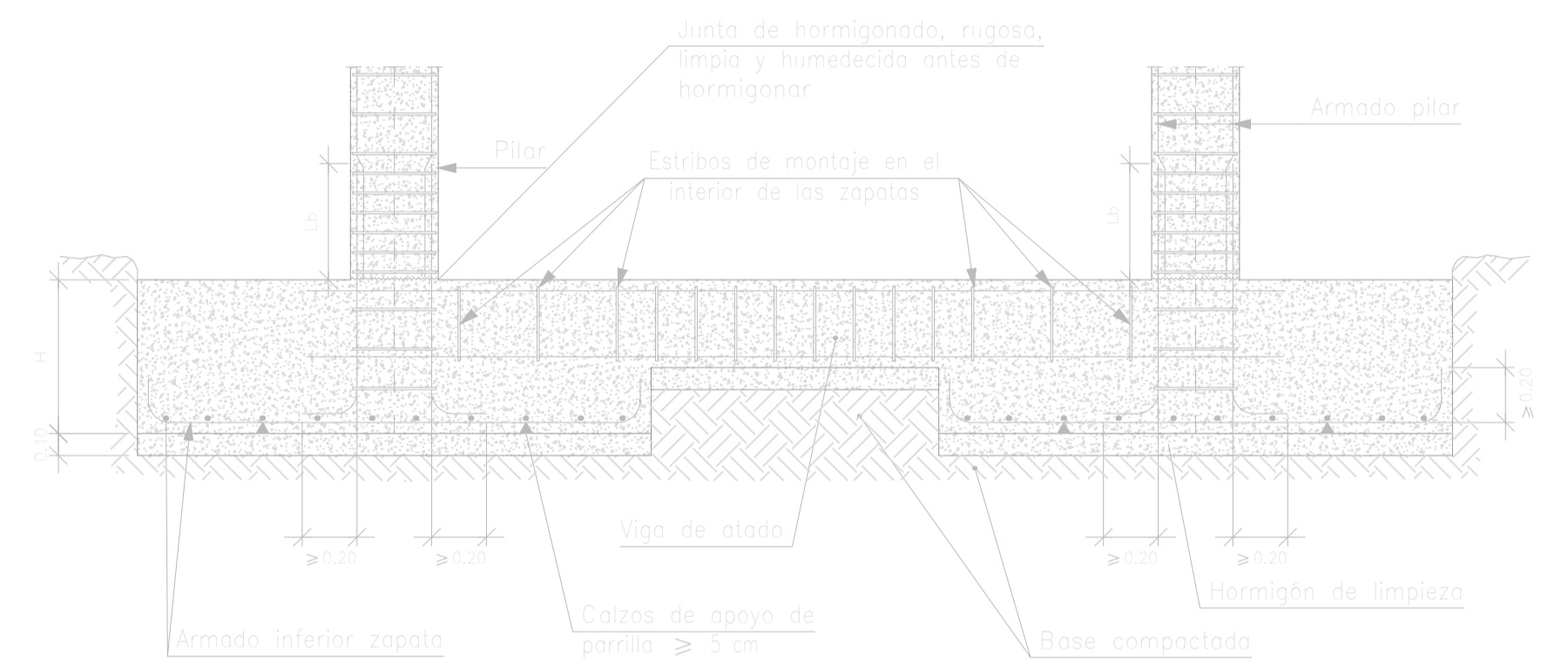

Detalle viga de atado entre zapatas
e 1.20

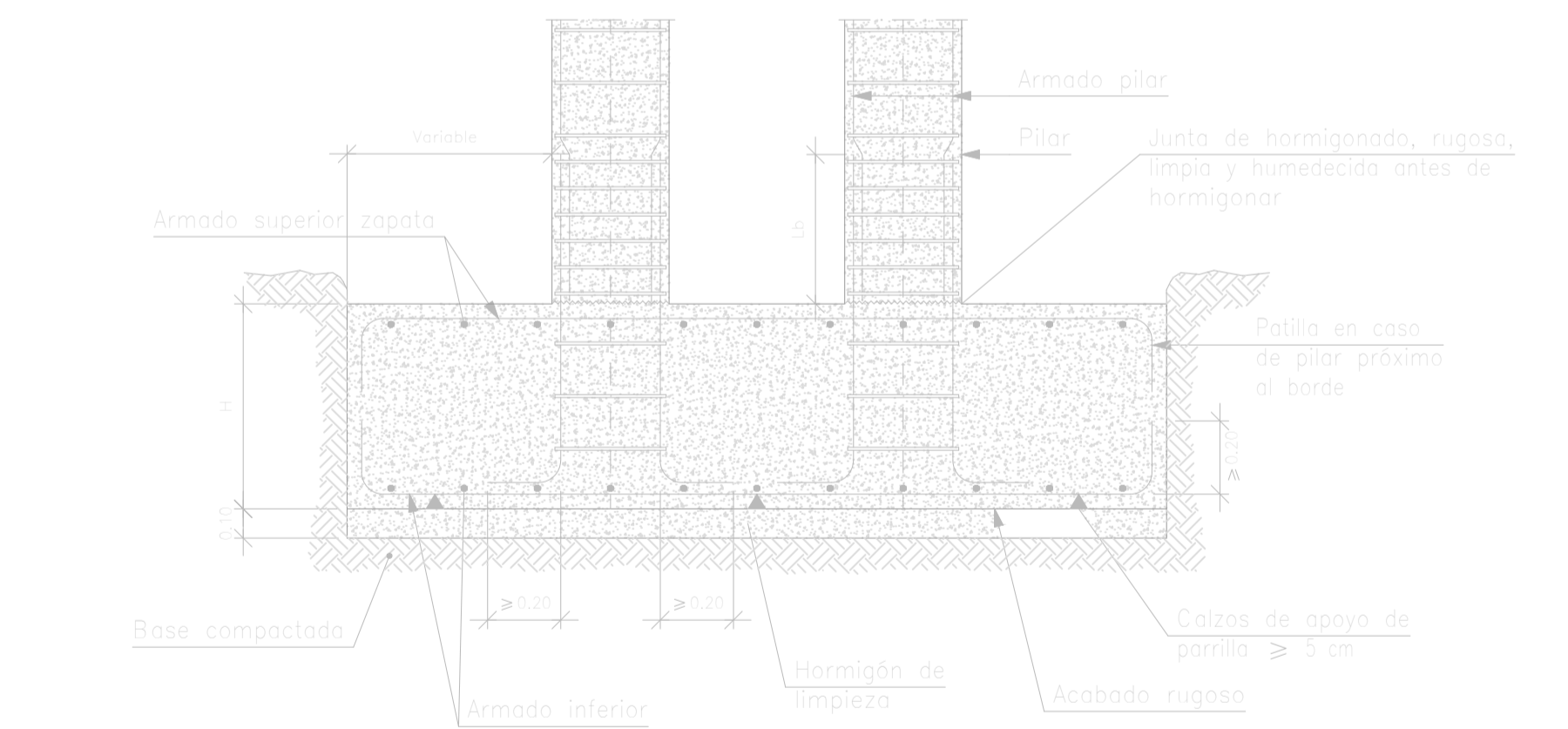

Detalle zapata combinada de pilares
e 1.20

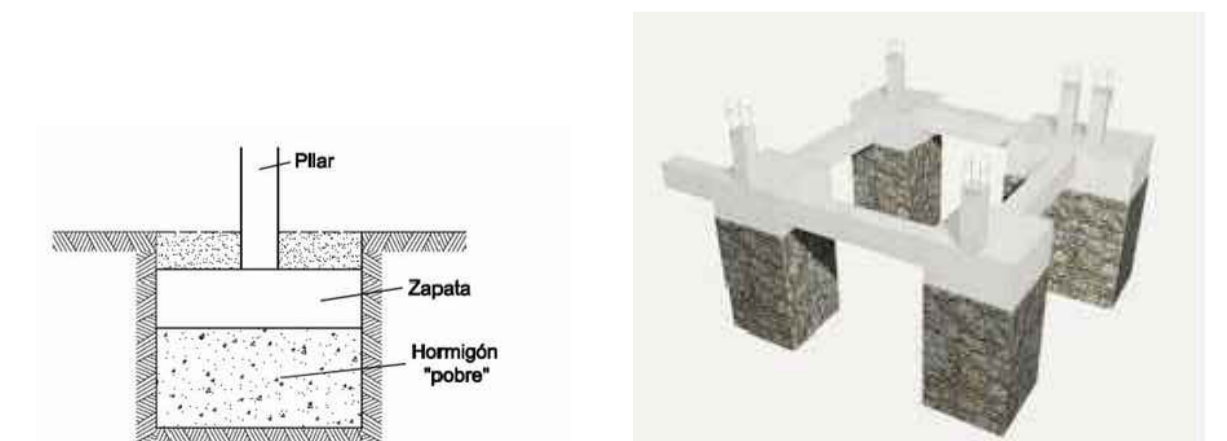

Imágenes zapatas aisladas sobre pozos de cimentación
Fuente: web Geotecnia Fácil